



HYDRAULIC POWER UNITS
HPT-SB-ALL
POWER POINT PRESENTATION
SLS & MKTG
ENGLISH

DOC NO.: 100-510-65348

1

HYDRAULIC POWER UNITS

STORM BRAKES

1.0 Hydraulic power units storm brake series



HPT04-SB



HPT08-SB

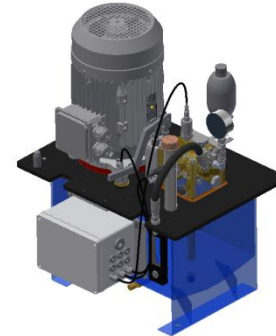

HPT20-SB

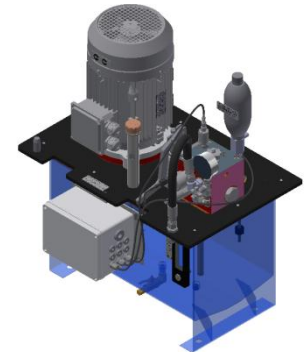

HPT40-SB

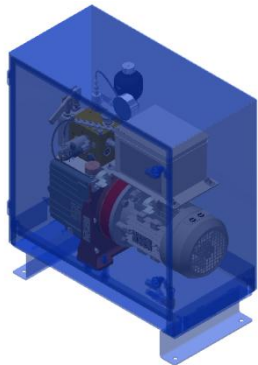

**HPT04
SBS4EN**

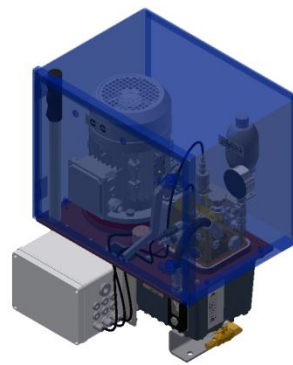

**HPT08
SBS4EN**

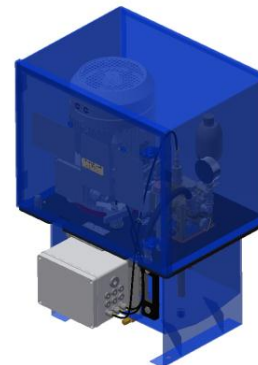

**HPT20
SBS4EN**

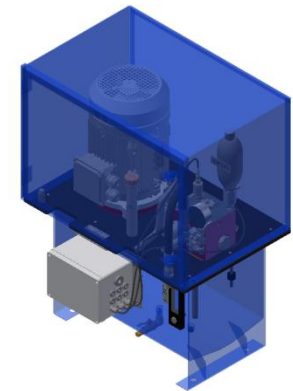

**HPT40
SBS4EN**

2.0 Hydraulic power unit manifold models

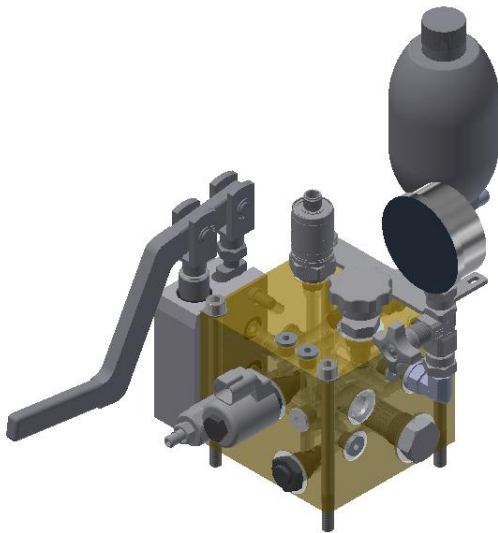

MB1V3

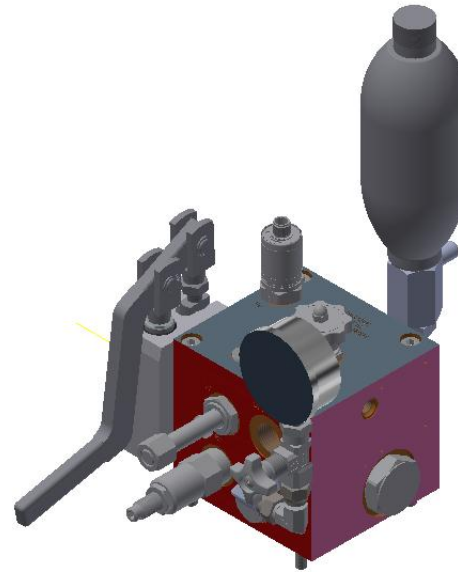

MB2V2

Hillmar manifolds are manufactured standard in aluminum

3.0 Principle of Operations

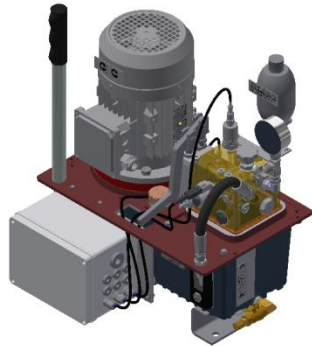

**DIE CAST
RESERVOIR**

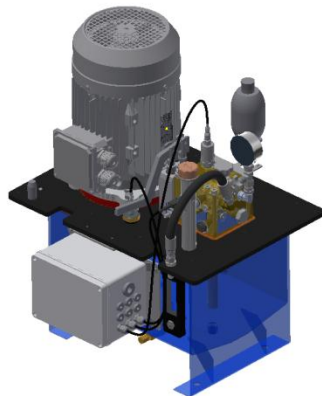

**STAINLESS STEEL
RESERVOIR**

- All HPT system components are modular and easy field replaceable.
- Each HPT hydraulic system is supplied standard as a non-constant running system.
- Available in 5 size hydraulic systems 3 Die cast & 2 Stainless steel models.
- The hydraulic power unit runs until signal from either a pressure switch or proximity switch tells it to stop.
- The unit will remain shut down until internal system leakage reduces the system pressure thus activating an electrical signal to recharge the system.
- It should be noted that during operation system pressure is never allowed to drop below the minimum system release pressure.

4.0 Design Highlights

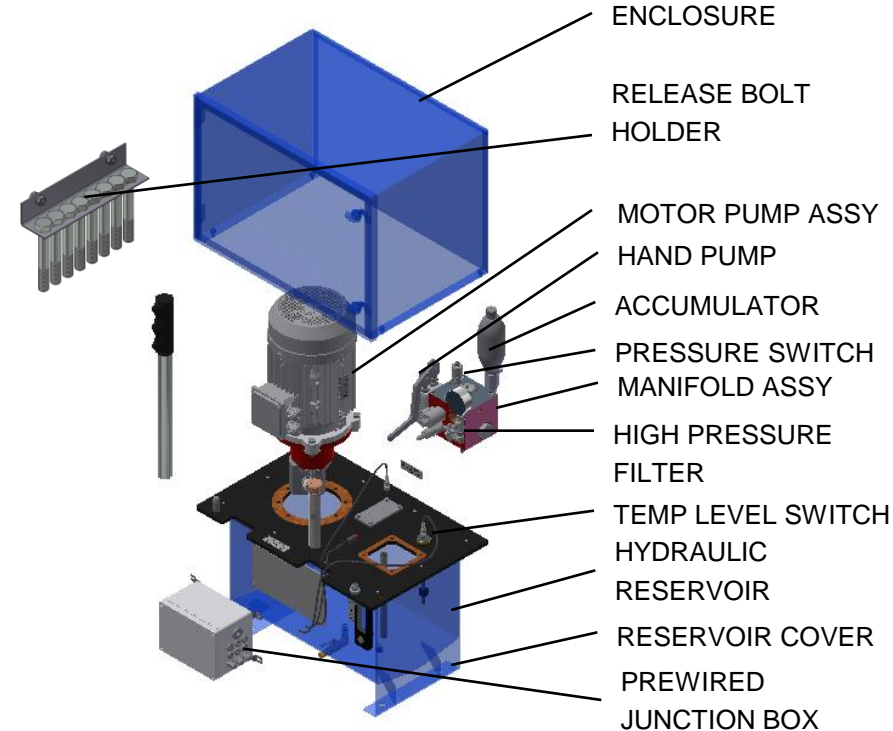

- All hydraulic components are field replaceable without having to remove reservoir cover.
- Stainless steel (304) reservoir on 20 and 40 liter models.
- All fasteners stainless steel (316) standard.
- Hand pump design for product manual release.
- All hydraulic hose comes complete with type & date marks.
- High pressure filter with field replaceable element.
- System components standard from brand name manufacturers.

5.0 Standard Features

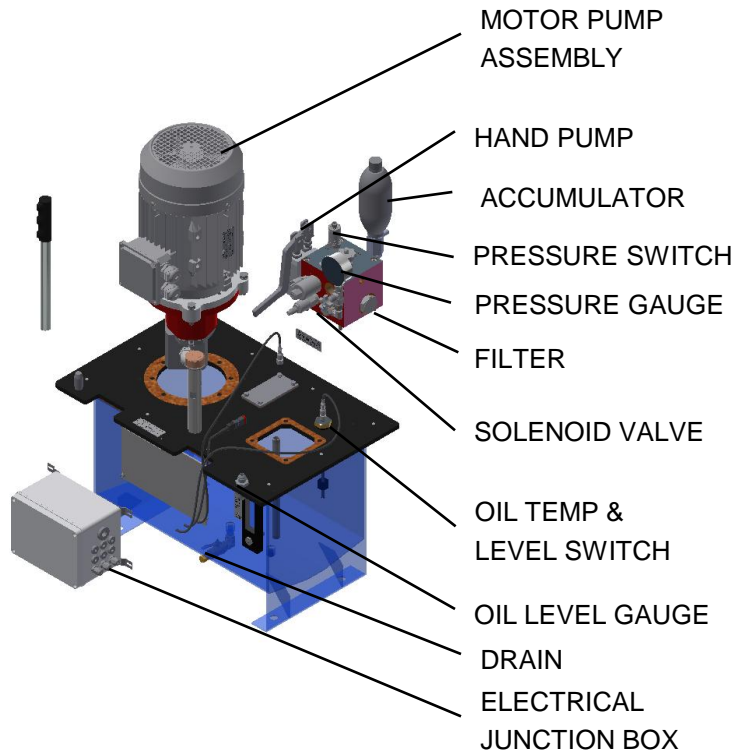

- Hand pump for manual release.
- Solenoid valve with LED indicator.
- Stainless steel (304) reservoir on 20L & 40L models.
- Stainless steel (316) fasteners.
- IP55 rated electrical motor & junction box.
- All system components designed for maximum 20MPa operating pressure.
- Reservoir accessories standard including:
 - ❖ Oil temperature level switch.
 - ❖ Oil level Gauge.
 - ❖ High pressure filter.
 - ❖ Reservoir drain shut off valve.
 - ❖ Pressure switch.
 - ❖ Accumulator.
 - ❖ Pressure Gauge.
 - ❖ All components field replaceable.

6.0 Design Options

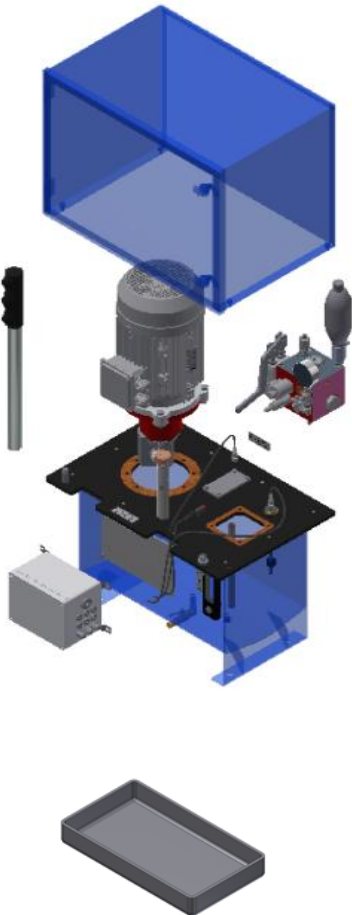

- Stainless steel (316) enclosure
- Oil drip pan
- Hose and fitting kits
- CSA certification or CSA ready
- Explosion proof
- Reservoir heater
- Motor strip heater
- Stainless steel junction box upgrade
- Weather stripping
- Non standard voltages
- Custom electrical configuration
- Stainless steel label kits

7.0 Standards

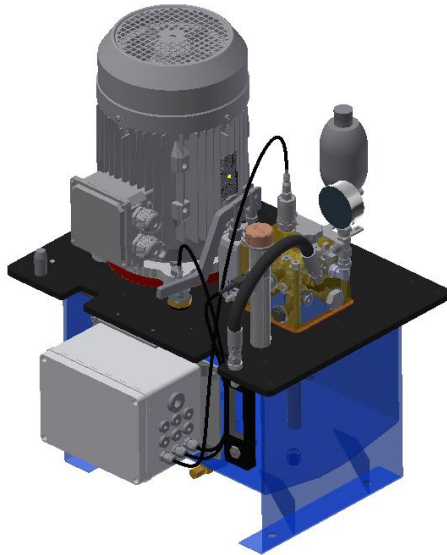

All Hillmar products are designed & manufactured in accordance with the following standards.

7.1 Design standards.

7.2 Performance standards.

7.3 Document standards.

7.4 Production & Quality standards.

7.5 Packaging standards.

All Hillmar products are delivered with Hillmar commitment to customer satisfaction.

All Hillmar products manufactured in accordance with DIN 10204-2.1

Hillmar is an ISO 9001:2008 certified company.